

## A YEAR OF PROGRESS, PLANNING & EXCITEMENT

June 1, 2006

Dear Supporters,

This has been an incredibly exciting and busy year for the International Quilt Study Center. During this critical transitional year for the Center, the staff and I conferred with architects to finalize construction documents for the striking new home for the Center and marked the beginning of construction with a groundbreaking ceremony. We also developed an exhibition schedule for the next five years, refined plans for the opening exhibitions and companion publications, and continued to welcome visitors from near and far.



Since our program's beginnings, the support of the College of Education and Human Sciences and the Department of Textiles, Clothing and Design has been critical to our success. During this last year, Dean Marjorie Kostelnik and Department Chair Michael James have continued that tradition; we are grateful for the advice and perspective they contribute to our growth. In addition, we are aided by numerous departments and individuals throughout the University and look forward to these ongoing partnerships.

We are encouraged by the outpouring of enthusiasm from supporters around the world for construction of the Center's new home. I am excited to report that to date more than 66 percent of the \$12 million building campaign goal has been raised by the University of Nebraska Foundation. Meaningful opportunities remain to support the project at any level, and I thank you for your continued involvement as we realize our ambitious plans for the future.

Sincerely,



Patricia Crews  
Willa Cather Professor of Textiles & Director

### Building Our New Home

The embodiment of a far-sighted vision is about to become reality: only one short year after announcement of the building architect and the launch of a major capital campaign, the new home for the International Quilt Study Center is under construction. University of Nebraska-Lincoln officials, Lincoln Mayor Coleen Seng and more than 150 well-wishers celebrated the official groundbreaking for the new International Quilt Study Center building on May 12.

The festivities included the ceremonial turning of earth and a special quilting tradition. Attendees autographed signature quilt blocks which will remain in the Center's archives. A special surprise underscored the University's commitment to neighborhood connections: Quilt Center volunteers presented the captain and crew of next door neighbor Fire Station #2 with a specially designed quilted wall hanging.

"The new quilt study center has the potential to become a nationally-known destination not only for quilt enthusiasts, but also for historians and students of textile sciences," said UNL Chancellor Harvey Perlman. "This will be a significant resource for our students and faculty as well as the immediate community, the state and the nation."

The 37,000-square-foot building, under construction at North 33rd and Holdrege streets, is scheduled to open to the public in early 2008. The Quilt Center will house three exhibition galleries, and state-of-the-art textiles storage and quilt preservation facilities.

*-Continued on page 2-*

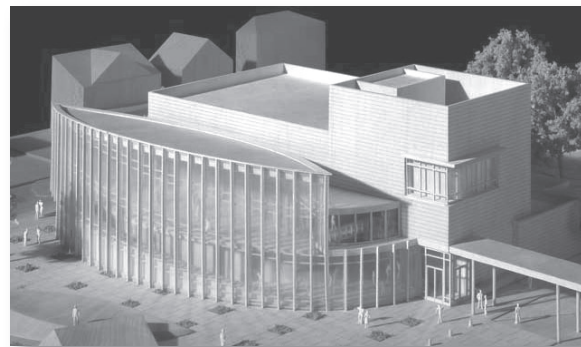

## COLLECTIONS

### New Acquisitions

The International Quilt Study Center's acquisitions committee approved the addition of more than 200 new quilts last year with support of private acquisition funds. Hundreds of quilts were located, researched and examined as possible additions in these priority areas – early American, international traditional, and domestic and international contemporary art quilts.

Highlights from new acquisitions include:

- Kathryn Berenson Collection of French Quilts and Textiles, a rare and unusual group of 18th- and 19th-century white-work, silk, and printed cotton quilts;
- A group of *rallis* or quilts made in the Thar Desert region located on the border of Pakistan and India, and
- Two Log Cabin quilts from Norway.

In addition, contemporary art quilts from British artists Pauline Burbidge, Deirdre Amsden, Lynn Settrington and Mary Fogg were acquired, as were quilts of American artists Jan Myers-Newbury, Emily Richardson, Chris Wolf Edmonds, Ruth B. McDowell and Barbara Watler.



Ralli Quilt, made in India or Pakistan, c. 1970-1990. IQSC 2005.033.0017



Barbara Watler, "Fingerprint Series: #8 Centering In," 1999, Hollywood, FL. IQSC 2005.030.0003

### Collections Care

Due to the growth of the collections, new shelving units were installed to expand storage capacity in the Center's storage facility. Additional archival boxes and tissue were also purchased to properly store and care for the collection.

With the help of our dedicated volunteers, we completed object surveys for over 150 quilts. Information on individual quilts retrieved from the object surveys will be available on our searchable database to the general public.

Nearly 100 quilts were on view at local, national and international exhibitions. Thanks to our volunteers, as the quilts returned from exhibitions they were carefully vacuumed using low-suction vacuums to remove dust from the surface of the quilts that may have accumulated during the course of exhibitions.

The total number of volunteer hours accumulated during 2005-2006: 1275. We could not take care of the collections as well as we do without our dedicated corps of volunteers!

### Building, *continued from page 1*

Funding for the \$12 million building is being raised solely from private donations by the University of Nebraska Foundation, including a lead gift from the Robert and Ardis James Foundation. "This is yet another example of what can be done when private resources are combined to take the university to new levels of quality," said University of Nebraska Foundation CEO Terry Fairfield. "We are extremely thankful to Bob and Ardis James and the many other donors for their support and vision, which is making this center and program a reality."

Greg Jensen, Senior Director of Development for the NU Foundation, has worked directly with individuals around the world, as well as numerous quilting guilds, which have pledged support to the building fund. There will be several naming opportunities within the new building. To learn more about these and other ways to join our list of supporters, contact:

Greg Jensen

University of Nebraska Foundation

1010 Lincoln Mall, Ste.300

Lincoln, NE 68508

402-472-0423

Email (*before 7/1/06*): [gjensen@foundation.nebraska.edu](mailto:gjensen@foundation.nebraska.edu), (*after 7/1/06*): [gjensen@nufoundation.org](mailto:gjensen@nufoundation.org)

## ANNUAL REPORT 2005-2006

### PUBLIC PROGRAMMING

#### Lectures and Public Programs

- “Patriotic Quilts” lecture by Julie Powell, collector and dealer of patriotic quilts and textiles, Lincoln, NE, August 29, 2005.
- “Amish Quilts and Quiltmakers,” Invited lecture by Patricia Crews held in conjunction with exhibition of Amish Quilts from the International Quilt Study Center’s Collections at Sookmyung Women’s University, Seoul, Korea, October 14, 2005.
- Third Annual Quilt Identification Day, Lincoln, NE, July 16, 2005. Quilt ID Day 2005 had 20 participants who brought a total of 34 quilts for identification.
- “Nebraska Quilts and Quiltmakers,” lecture by Patricia Crews, February 16, 2006, as part of the Nebraska State Historical Society luncheon seminar series. Broadcast almost daily over local public access channel during February and March.
- “The Underground Railroad Quilt Controversy: Looking for the ‘Truth’” public lecture by Laurel Horton, IQSC 2005-2006 Visiting Scholar, March 22, 2006.



Quilt I.D. Day,  
July 16, 2005

#### 2007 Symposium Planning

The International Quilt Study Center’s third biennial symposium (March 1-3, 2007) will explore the full breadth of contexts, both formal and informal, in which the quiltmaker’s art is learned, studied, applied and handed on. This will include but is not limited to: historical to contemporary, local to global, mainstream to alternative, self-taught to apprentice, church group to cooperative, workshop to academic coursework. How quiltmakers teach and learn from quilts, how the tactile resonance of quilts influences the education of the women and men who work with them, how new technologies impose changes in quilt and textile craft education—these and other topic areas will form the core of “Traditions and Trajectories: Education and the Quiltmaker.”



#### Exhibitions

Public exhibitions of the Center’s quilts are in high demand. The very limited exhibition space at the current Quilt Center facility necessitates use of other local, national and international venues to show quilts from the growing collection. During the last twelve months visitors attended the following exhibitions:

- *Patchwork Lives*, hosted by the Museum of Nebraska History. Exhibition curators: Carolyn Ducey and Stephanie Higgins.
- *The Collector’s Eye: Amish Quilts from the International Quilt Study Center Collections*, hosted by Sookmyung Women’s Univ., and Chojun Textile and Quilt Art Museum, Seoul, South Korea. Exhibition curators: Carolyn Ducey, Michael James, and Jonathan Holstein.
- *Wild by Design: 200 Years of Innovation and Artistry in American Quilts*, hosted by the Museum of Nebraska Art, Kearney. Exhibition curators: Janet Berlo, Patricia Crews, and Carolyn Ducey.
- *Perfecting the Past: Colonial Revival Quilts*, hosted by the Robert Hillestad Textiles Gallery, UNL. Exhibition curator: Melissa Slaton.

In addition, the Center has loaned individual quilts to galleries around the country. The Delaware History Center (Wilmington, Delaware), Racine Art Museum (Racine, Wisconsin), and Loves Jazz and Arts Center (Omaha, NE) have all borrowed quilts to augment their exhibitions.

See back cover for the schedule of current and upcoming exhibitions.



## RESEARCH AND EDUCATION

### Quilt Studies Graduates

- Kathleen Moore, M.A., August 2005
- April Paschall, M.A., May 2006
- Judy Schwender, M.A., May 2006
- Melissa Jurgena, PhD., May 2006

### Publications

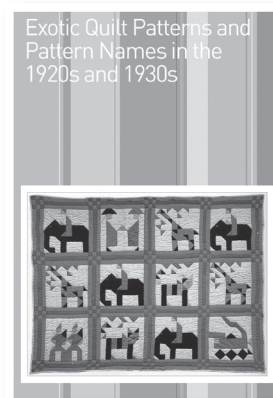

- Marin Hanson, "Exotic Quilt Patterns and Pattern Names in the 1920s and 1930s," *Textile: The Journal of Cloth and Culture*, Vol. 4., No. 2 (Summer 2006), pp. 138-163.

- Erika Takamura, Kunio Yoshizumi, and Patricia Crews, "Photoyellowing and Photo-Bleaching of Silk and Wool Fabrics under Monochromatic and MultiChromatic Light Radiation," *American Institute for Conservation, Textile Specialty Group Postprints*, Vol. 15 (2005), pp. 75-82.

- Carolyn Ducey, "Important Textile Collections: The International Quilt Study Center," *Surface Design*, Vol. 30, No. 2 (Winter 2006), pp. 46-47.

- Helen Ewer, "Four Block Quilts," *Blanket Statements*, Newsletter of the American Quilt Study Group, Fall 2005, pp. 8-9.



### Presentations at National Meetings

- "Gilded Age Quilts: Products of America's Ambivalence towards Modernization," Marin Hanson, Juried paper presented at the Salve Regina University Annual Conference on Cultural and Historic Preservation, Newport, RI, September, 2005.

- "Photoyellowing and Photo-Bleaching of Silk and Wool Fabrics under Monochromatic and MultiChromatic Light Radiation," Erika Takamura, Kunio Yoshizumi and Patricia Cox Crews, American Institute for Conservation Annual Meeting, Minneapolis, MN, June 12, 2005,

- "University Collections and Faculty Accountability," Patricia Crews, Special Panel Presentation, International Textile and Apparel Association Annual Meeting, November 4, 2006.

- "Quilt Studies after Gee's Bend," Patricia Crews, Invited Panelist with Laurel Thatcher Ulrich of Harvard, and Elsa Barkley of University of Maryland. Held at Auburn University, Auburn, AL, in conjunction with "Quilts of Gees Bend" exhibition, December 1, 2005.

- "How Science and History Fueled An Academic Career," Patricia Cox Crews, Distinguished Scholar Invited Presentation at Annual Meeting of the International Textile and Apparel Association, Washington, DC, November 3, 2005.

### Assistants and Interns



Melissa Slaton, the Center's curatorial graduate assistant, completed the final year of her assistantship, curating the exhibition "Perfecting the Past: Colonial Revival Quilts" as her culminating Master's project.

### Summer Seminars and Workshops

#### 2005 Summer Seminar

- "A Century of Quilts in Women's Lives," taught by Virginia Gunn, Professor, University of Akron.

#### Upcoming 2006 Summer Workshop

- "Investigating and Interpreting the Past: The Study of Material Culture," June 19-23, Patricia Crews and Susan Wunder, Professors, University of Nebraska-Lincoln.

Elizabeth Stetson, the Center's UCARE (Undergraduate Creative and Research Experiences) student, completed her two-year appointment by presenting information at a poster session on the work she did to help prepare for the upcoming exhibition, "Reading, Writing, and a Rhythmic Stitch."

Master's students Kim Madsen and Christina Brooks completed Spring internships at the Center assisting with various research assignments related to the Getty Catalogue Project (see p. 5).

## HONORS AND GRANTS

### Honors

- Patricia Crews, Named 2006 Distinguished Scholar of the International Textile and Apparel Association.
- Patricia Crews, Named Centennial Laureate by Florida State University Alumni Association, Out of an alumni base of 12,000, FSU selected only 200 to receive this honor.
- Jonathan Gregory, Recipient of the Barbara L. Kuhlman Foundation scholarship awarded to full time students in fiber arts programs with a minimum 3.0 GPA.
- Janet Price, Recipient of 2006 Lincoln Quilters Guild Scholarship Award to support travel for oral interviews of Grace Snyder's daughters.
- Nao Nomura, Recipient of 2006 Lincoln Quilters Guild Scholarship Award to support American Quilt Study Group seminar registration. Nao and Janneken Smucker will present a co-authored paper, "From Fibers to Field Work: a Multifaceted Approach to Re-examining Amish Quilts."

### Grants

- Nebraska Humanities Council awarded \$2350 in support of the exhibition "Perfecting the Past: Colonial Revival Quilts."
- Nebraska Arts Council awarded \$650 Special Opportunity Support grant for professional development (supported Maureen Ose's attendance at the American Association of Museums annual meeting in Boston).

### Getty Grant Program Project Update

In 2004, the Getty Foundation's Grant Program awarded the International Quilt Study Center a three-year grant (\$175,000) to research and prepare the manuscript for the inaugural volume of an eventual four-volume catalogue of the IQSC collections. This volume, tentatively titled "American Quilts in the Modern Age: 1870-1940," will be co-edited by Marin Hanson, Curator of Exhibitions, and Patricia Crews, Director.

In this second year of the grant, we made significant progress towards the project's completion. We wrapped up data collection on the 550 quilts that will be included in the volume. In addition, we finalized the genealogical research that was begun last year on the known makers represented in the volume. Finally, more than two-thirds of the essays and catalogue entries for the manuscript have been completed and are awaiting editing, which begins this summer.



### Online Database

The online quilt database at <[www.quiltstudy.org/search](http://www.quiltstudy.org/search)> remains the most popular page on the Quilt Center's website. In 2005, the page received a total of 124,374 hits. In Spring 2006, the database was updated to include most of the more than 200 quilts acquired in 2005.

Many visitors to the website register to receive the electronic Quilt of the Month. There are currently 2540 QOM subscribers.



*Nao Nomura, Collections Manager, and Laurel Horton, 2005-2006 Visiting Faculty Fellow*

## Fellows, Advisory Boards and Staff

### IQSC Faculty Fellows

Barbara Banks, Lentz Center for Asian Culture  
 Peter Bleed, Anthropology  
 Mary Cassner, UNL Libraries  
 Patricia Crews, IQSC; Textiles, Clothing & Design  
 Jan Driesbach, Sheldon Memorial Art Gallery  
 Carolyn Ducey, IQSC  
 Mary Ellen Ducey, Special Collections/Archives  
 Marin Hanson, IQSC  
 Michael James, Textiles, Clothing & Design  
 Karen Janovy, Sheldon Memorial Art Gallery  
 Wendy Katz, Art and Art History  
 Margaret Latta, Teaching, Learning & Teacher Ed.  
 Shirley Niemeyer, Textiles, Clothing & Design  
 Marshall Olds, Modern Languages & Literature  
 Joy Ritchie, Women's Studies and English  
 Kari Ronning, UNL Cather Project  
 Dan Siedell, Sheldon Memorial Art Gallery  
 Alison Stewart, Art and Art History  
 Barbara Trout, Textiles, Clothing & Design  
 Diane Vigna, Textiles, Clothing & Design  
 Wendy Weiss, Textiles, Clothing & Design  
 Kenneth Winkle, History

### 2004 International Advisory Board Members

Xenia Cord of Indiana  
 Sara Dillow of Nebraska  
 Annette Gero of Australia  
 Brenda Groelz of Colorado  
 Bettina Havig of Missouri  
 Jonathan Holstein of New York  
 Michael James of Nebraska  
 Ralph James of Massachusetts  
 Robert & Ardis James of New York  
 Gita Khandelwal of India  
 Soon-Hee Kim of South Korea  
 Bridget Long of England  
 Mieko Miyama of Japan  
 Yvonne Porcella of California  
 Olga Prins-Lukowski and Simon Prins of the Netherlands  
 Donna Wilder of Connecticut  
 Alice Zrebiec of New Mexico

### IQSC Chancellor's Quilt Advisory Committee

Shelly Burge of Lincoln  
 Jean Davie of Lincoln  
 Mary Ghormley of Lincoln  
 Elaine Martin of North Platte  
 Jo Morton of Nebraska City  
 Paulette Peters of Elkhorn  
 Susan Seidel of Omaha  
 Diann Sorensen of North Platte  
 Dianne Thomas of Omaha  
 June Vogltance of Dodge  
 Chris Wiegers of Beatrice  
 Linda Winter of Holdrege

### IQSC Associate Fellows

Linda Arthur, Washington State University  
 Jacqueline Atkins, Allentown Art Museum  
 Lynne Z. Bassett, Ware, MA  
 Janet Berlo, University of Rochester  
 Barbara Brackman, Lawrence, KS  
 Glen Brown, Kansas State University  
 Dorothy Caldwell, Hastings, Ontario, Canada  
 Robert Cargo, Tuscaloosa, AL  
 Ricky Clark, Oberlin, OH  
 Raymond Dobard, Howard College  
 Linda Eaton, Winterthur Museum  
 Judy Elsley, Weber State University  
 Sandi Fox, Los Angeles, CA  
 Annette Gero, Univ. of New South Wales, Australia  
 Jennifer Gilbert, New England Quilt Museum  
 Jennifer Goldsborough, Parson's School of Design  
 Virginia Gunn, University of Akron  
 Marilyn Henrion, New York, NY  
 Bernard Herman, University of Delaware  
 Jonathan Holstein, Cazenovia, NY  
 Laurel Horton, Seneca, SC  
 Mary Anne Jordan, University of Kansas  
 Stacy Kamehiro, University of California, Santa Cruz  
 Bridget Long, Hertfordshire, England  
 Marsha MacDowell, Michigan State University  
 Terrie Hancock Mangat, Valdez, NM  
 Ronald Naugle, Nebraska Wesleyan University  
 Ellen Oppenheimer, Oakland, CA  
 Margaret Ordonez, University of Rhode Island  
 Dorothy Osler, Northumberland, England  
 Rachel Pannabecker, Kauffman Museum  
 Jane Przybysz, San Jose Museum of Quilts & Textiles  
 Joy Saville, Princeton, NJ  
 Robert Shaw, Shelburne, VT  
 Janneken Smucker, University of Delaware  
 Marybeth Stalp, University of Northern Iowa  
 Patricia Stoddard, Provo, UT  
 Susan Torntore, Iowa State University  
 Maude Wahlman, Univ. of Missouri - Kansas City  
 Merikay Waldvogel, Knoxville, TN  
 Janice Wass, Illinois State Museum  
 Linda Welters, University of Rhode Island  
 Jenny Yearous, North Dakota State Historical Society  
 Shelly Zegart, Alliance for American Quilts

### IQSC Staff

Patricia Crews, Director  
 Carolyn Ducey, Curator of Collections  
 Marin Hanson, Curator of Exhibitions  
 Nao Nomura, Collections Manager  
 Maureen Ose, Communications Coordinator  
 Kathy Moore, Symposium Coordinator  
 Melissa Slaton, 2004-2005 Graduate Curatorial Assistant  
 Rosanne Samuelson and Sharon Reeder, Support Staff  
 Jean Davie, Volunteer Coordinator

## *ANNUAL REPORT 2005-2006*

### International Quilt Study Center Annual Supporters – June 2005 – June 2006

Gifts to the Annual Support Fund provide much needed support for the operational collections care activities of the International Quilt Study Center and are greatly appreciated. Other donors not recognized within this report include those who have provided important support for the capital campaign fund and endowment fund managed by the University of Nebraska Foundation.

#### *Benefactor Level (\$1,000 and above)*

Meyer J. and Norma Ragir Foundation  
Pete and Linda Claussen  
Mark and Diann Sorensen

#### *Patron Level (\$500-\$999)*

Edith Garey  
Patricia Heaton  
Joan Laughlin  
Patricia Layman Short  
John M. Walsh, III

#### *Sponsor Level (\$250-\$499)*

Hazel M Anthony  
Bill and Carlene Hall  
Robert Hillestad  
Ted McMinn  
Daniel and Shirley Neary  
Ruthanna Russel  
Susan Salser  
Duane and Betty Starr

#### *Associate Level (\$100-\$249)*

Kim Baird  
Lynne Z Bassett  
David and Jo Baxter  
Sherry Boram  
Robert Busha and Kay Taber  
Katy Christopherson  
David and Patricia Crews  
Linda Daiker  
Carroll Dischner  
Janet and Carl Eskridge  
Joanne Gasperik  
Ordella Geisler  
Roger and Mary Ghormley  
Fred and Mary Anne Guggenmos  
Virginia Gunn  
Leo and Joyce Harvill  
DeLynn and Esther Hay  
Carolyn Hoefer  
Michael and Judy James  
Betty Ann Johnson  
Carmen Kleager  
Ted Kooser and Kathleen Rutledge  
Sarah M Lahr  
Phyllis Lahrs  
Timothy and Linda Loker  
Jeffery and Kaye MacDonald  
Martin and Ruth Massengale  
Margaret M McAllaster  
Penny McMorris  
Lillian Mesner  
Jan Myers-Newbury  
Darrell and Nan Nelson  
Shirley Nowakowski  
Louis Paglia  
Mary L. Stephenson Pearson  
Jane B Phelps  
Deborah Rake  
Stella Schaffert  
Judy Schwender

Janet L Sullivan  
Odette Goodman Teel  
Merikay Waldvogel  
Joan Meyer White  
Lynn White and David Brinkerhoff

#### *Guild/Organization (\$125)*

Braided River Quilt Guild  
Cabin Fever Quilters Guild  
Camellia Quilters  
Christie Heights Quilters  
Fat Quarters Evening Quilt Guild  
Kaw Valley Quilters Guild  
Nimble Thimble Quilt Guild  
Quilters Guild of Greater Kansas City  
Rock Creek Quilters  
Sandhills Quilt Guild  
Tucson Quilters Guild

#### *Individual/Family Level (\$40)*

Diane Ajuria  
Janet E Ambrose  
Melinda Anderson  
Kathy Ayer  
Catherine Bailie  
Rosalie Barabas  
Ken and Maxine Bergen  
September Bowman  
Margaret S and James M. Bresel  
Patricia Brown  
Marjorie Busby  
Betty Ann Carter  
Ricky Clark  
Judith Clark  
Pat Cole  
Deborah A Csere  
Kent and Janice Eakins  
Michele Eakins  
Laura Edwards  
Kenneth and Cynthia Erdman  
Laura Erickson  
Margaret Ferguson  
V. R. Fike  
LeAnn Larson Frobom  
Marie Glenn  
Ann Goodpasture  
Pat and Lewis Hackley  
Linda and Terry Hall  
Bettina Havig  
Ginnie Hebert  
Carol Hoffman  
Karen Janovy  
Marie Johansen  
Jean W. Keenan  
Alice Kinsler  
Marsha and Jeff Kinyoun  
Nancy Knuth  
Karen Krause  
Janet K Kugler  
Robbie Lonewolf  
Linda MacDonald  
Carolyn Maller

Mary Marks  
Therese May  
Beverly and Rick Mayfield  
Christine Milodragovich  
Sharon Mohatt  
Jeanne C Murray  
Karen Newland  
Margaret Norton  
Margaret Ordenez  
Carol Palmeiro  
Mary Persyn  
Miriam Peterson  
Curtis and Gladys Phillips  
Mary Richling  
Gary and Jan Rodgers  
Louie and Kathi Rotella  
Karen Segall  
Susan Seidel  
Sally Ann Sellers  
James and Lisa Steward  
Ruth Vidunas  
Janice Tauer Wass  
Yvonne Wells  
Linda Welters  
Lois Wilson  
Mitchie and Cheryl Woerner  
Jim and Becky Woerner  
John and Linda Woerner  
Robert and Darlene Woerner  
Beth Woerner  
Tracy Zentner

#### *Senior Level (\$35)*

Irma Alcorn  
Norma Bliss  
Maura Clark  
Patricia Delphia  
Radka Donnell  
Donna Elvik  
Elaine Finke  
Joyce Fisher  
Judy Hess  
Ellan Hove  
Peggy Ingram  
Yvonne Junge  
Irene R LeBaron  
Sylvia L. Lell  
Kathryn E. Lohr  
Jack and Carol Maddux  
Marilyn McCord  
Janet M Meyer  
Jane Munson  
Linda Reynolds  
LaVonne Rohlf  
Charlotte E Smith  
Gladys Sorensen  
Rose Marie Tondl  
Elizabeth Williamson

#### *Student Level (\$25)*

Peggy Derrick  
Kimberlee Madsen



The University of Nebraska-Lincoln is an equal opportunity educator and employer with a comprehensive plan for diversity.

## Exhibitions

In Lincoln, NE:  
*Perfecting the Past: Colonial Revival Quilts*  
Robert Hillestad Textiles Gallery, UNL  
May 30 - September 1, 2006  
*Reading, Writing and a Rhythmic Stitch*  
Great Plains Art Museum, UNL  
October 6, 2006 - March 28, 2007  
In Omaha, NE:  
*African American Quilts from the Cargo Collection*  
Loves Jazz and Arts Center  
June 16, 2006 - August 25, 2006  
In Kearney, NE:  
*Wild by Design*  
Museum of Nebraska Art, Univ. of Nebraska-Kearney  
April 8 - July 30, 2006  
In Grinnell, IA:  
*Indigo Gives America the Blues*  
Faulconer Art Gallery, Grinnell College  
July 21 - September 17, 2006



Ground Broken for the New Home of  
the International Quilt Study Center  
-See page 1 for story-

LOOKING AHEAD . . .